

# ADELPHI

## UNIVERSITY

**Located on Long Island with easy access to New York City, Adelphi University is the ideal place for your next meeting or event.**

### Comprehensive Planner Support

We know that you have many different options when it comes to choosing a location for your next meeting or event; however, when you choose Adelphi and put your trust in our team of event professionals, we take it seriously. We are with you every step of the way, from the contracting and planning phase, all the way through the execution of the event. We take the time to listen, to understand your goals and objectives, and use our expertise to support your planning efforts and achieve success. Because when you look good, we do, too.

### Comfortable Accommodations

With up to 500 semi-furnished bedspaces across seven residence halls, we are able to host groups of varying sizes from late-May through early-August each year. Adults enjoy our climate-controlled rooms with private baths, while youth participants experience true campus living in double- and triple-occupancy rooms. All halls feature fast Wi-Fi, free parking, community lounges, laundry and kitchens, and optional linen service.

### Outstanding Food & Beverage

Our culinary team is committed to providing you with the highest quality dining experience during your stay. From traditional cafeteria dining programs to exceptional catered meals to onsite retail dining options, we build the perfect service plan for your event. Our chefs prepare a wide range of cultural, ethnic, and sustainable food options suitable for all ages and regularly prepare vegetarian, vegan, and halal offerings that can be offered individually or for an entire group.





## Flexible Meeting Spaces

We offer the right mix of world-class facilities to support any camp, conference, workshop, meeting, or event: traditional classrooms and auditoriums, performance and workshop venues, flexible multi-purpose spaces, formal boardrooms, and outdoor and athletic fields. Many of our facilities have been recently renovated, including the new **Ruth S. Harley University Center**, completed in 2021.

Our meeting spaces are technologically rich, with either built-in smart technology or audio-visual equipment set for your use. Good lighting, comfortable seating, fast Wi-Fi, and onsite support ensure things run smoothly and attendees have a memorable experience.

Room	Capacity	Type
Adelphi Room	80	Multi-Purpose
Campbell Lounge	150	Multi-Purpose
PAC Black Box	90	Multi-Purpose
PAC Concert Hall	482	Theater
PAC Olmstead Theatre	306	Theater
PAC Breakout Rooms	36	Multi-Purpose
PAC Studio	170	Multi-Purpose
UC Ballroom	500	Multi-Purpose
UC 201/202	280	Multi-Purpose
UC 202/203	357	Multi-Purpose
UC 201	110	Multi-Purpose
UC 202	110	Multi-Purpose
UC 203	176	Multi-Purpose
UC Charter Room 210	18	Conference Table
UC 113/114/115	90	Multi-Purpose
UC Breakout Rooms	15-50	Multi-Purpose

**ADELPHI**  
UNIVERSITY

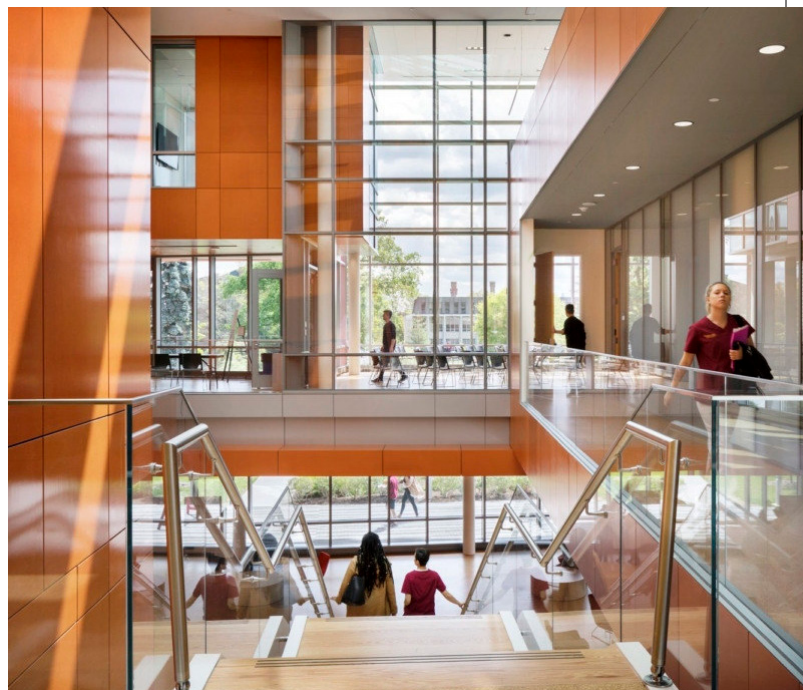

# Make it Eventful!

**For more information:**

[www.adelphi.edu/conference-event-spaces/](http://www.adelphi.edu/conference-event-spaces/)

**Contact us today:**

Email:

[conferenceservices@adelphi.edu](mailto:conferenceservices@adelphi.edu)

Phone: 516.877.3455

Fax: 516.877.3606